

| ROOF CONSTRUCTION                             |      |
|---|------|
| · COLORBOND ROOF WITH 50MM ANTICON INSULATION |      |
| · TILED ROOF WITH SARKING                     |      |
| MINIMUM RW VALUE                              |      |
| · BEDROOMS -                                  | RW46 |
| · LIVING AREA -                               | RW41 |
| STANDARD                                      |      |
| · NO ANTICON INSULATION                       |      |

| EAVE CONSTRUCTION             |  |
|-------------------------------|--|
| · ENCLOSED EAVES CONSTRUCTION |  |
| · 6MM DURASHEET               |  |
| STANDARD                      |  |
| · 4.5MM HARDIEFLEX            |  |

| WALL CONSTRUCTION                                    |      |
|--|------|
| · CLAY BRICK - MIN 90 MM THICK                       |      |
| · 50 MM CAVITY                                       |      |
| · 15MM FOILBOARD INSULATION PANEL WITH SPACER BLOCKS |      |
| MINIMUM RW VALUE                                     |      |
| · BEDROOMS -   | RW47 |
| · LIVING AREA -                                      | RW42 |
| STANDARD   |      |
| · DELETE 15MM FOILBOARD INSULATION                   |      |

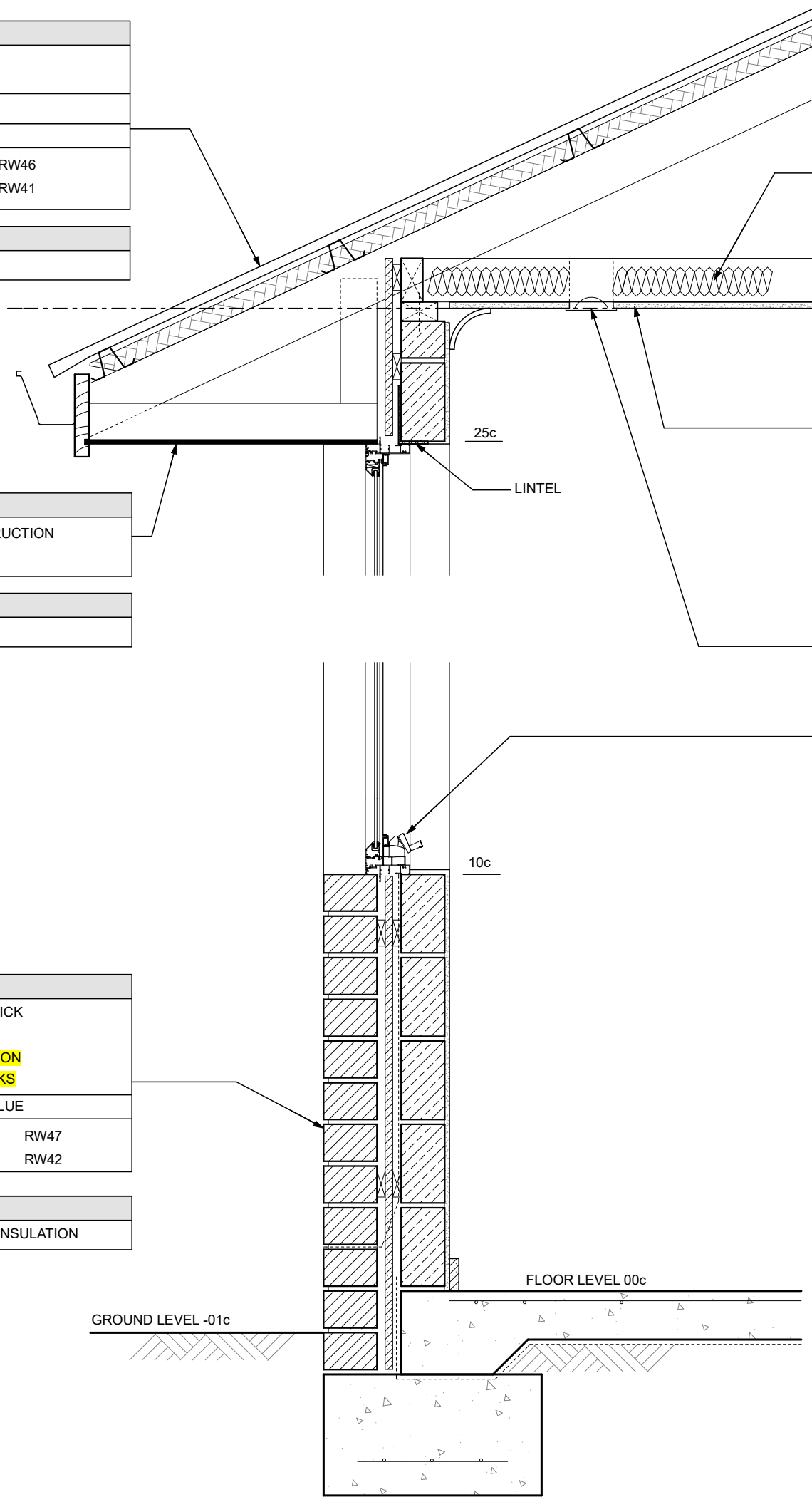

| CEILING INSULATION                     |  |
|--|--|
| · MIN 215MM GOLD BATTS R4.0 INSULATION |  |
| STANDARD                               |  |
| · R3.0 BLOWN-IN INSULATION             |  |

| CEILING CONSTRUCTION        |      |
|-----------------------------|------|
| BEDROOMS                    |      |
| · 1 X 13MM GYPROCK SOUNDCEK |      |
| LIVING/WET AREAS            |      |
| · 1 X 10MM GYPROCK SUPACEIL |      |
| MINIMUM RW VALUE            |      |
| · BEDROOMS -                | RW46 |
| · LIVING AREA -             | RW41 |

| STANDARD                      |  |
|-------------------------------|--|
| · 1 X 10MM GYPROCK THROUGHOUT |  |

| LIGHT FITTING                |  |
|------------------------------|--|
| · RECESSED LED LIGHT FITTING |  |
| · MAX 90 MM DIAMETER CUTOUT  |  |

| WINDOW CONSTRUCTION     |  |
|-------------------------|--|
| · AWNING STYLE OR FIXED |  |
| · COMPRESSED SEALS      |  |

| BEDROOMS  |  |
|---|--|
| · AGC STRATOPHONE ACOUSTIC GLAZING 7MM WITH RESIDENTIAL FRAME |  |
| · AGC STRATOPHONE ACOUSTIC GLAZING 11MM WITH BENCHMARK FRAME  |  |

| LIVING/WET AREAS  |  |
|---|--|
| · AGC STRATOPHONE ACOUSTIC GLAZING 7MM WITH RESIDENTIAL FRAME |  |
| · VLAM LAMINATE 6.38MM WITH RESIDENTIAL FRAME                 |  |

| MINIMUM RW VALUE |      |
|------------------|------|
| · BEDROOMS -     | RW36 |
| · LIVING AREA -  | RW29 |

| STANDARD                                |  |
|---|--|
| · LAMINATE 4.0MM WITH RESIDENTIAL FRAME |  |

| SLIDING DOOR CONSTRUCTION     |  |
|-------------------------------|--|
| · SLIDING DOORS MAX 2.7M WIDE |  |
| · COMPRESSED SEALS            |  |

| BEDROOMS  |  |
|---|--|
| · AGC STRATOPHONE ACOUSTIC GLAZING 7MM WITH RESIDENTIAL FRAME |  |
| · AGC STRATOPHONE ACOUSTIC GLAZING 11MM WITH BENCHMARK FRAME  |  |

| LIVING/WET AREAS  |  |
|---|--|
| · AGC STRATOPHONE ACOUSTIC GLAZING 7MM WITH RESIDENTIAL FRAME |  |
| · VLAM LAMINATE 6.38MM WITH RESIDENTIAL FRAME                 |  |

| MINIMUM RW VALUE |      |
|------------------|------|
| · BEDROOMS       | RW36 |
| · LIVING AREA -  | RW29 |

| STANDARD                                |  |
|---|--|
| · LAMINATE 4.0MM WITH RESIDENTIAL FRAME |  |

| SOLID DOOR CONSTRUCTION                        |  |
|--|--|
| · SOLID CORE EXTERNAL DOORS WITH WEATHER SEALS |  |

| MINIMUM RW VALUE |      |
|------------------|------|
| · BEDROOMS -     | RW36 |
| · LIVING AREA -  | RW29 |

### ACOUSTIC REQUIREMENTS TYPICAL WALL SECTION

**NOTES**  
 ALL DIMENSIONS AND LEVELS ARE TO BE CONFIRMED ON SITE BY CONTRACTORS PRIOR TO THE COMMENCEMENT OF ANY WORKS.  
 REFER TO ENGINEER'S DRAWINGS FOR STRUCTURAL AND CONCRETE WORK.  
 CONSTRUCTION DETAILS MAY VARY ON SITE AT THE BUILDER'S DISCRETION.  
 DO NOT SCALE FROM DRAWINGS.  
 EACH DRAWING SHALL BE READ IN CONJUNCTION WITH ALL OTHER DRAWINGS, SPECIFICATIONS AND REPORTS.  
 THE BUILDER RESERVES THE RIGHT TO MAKE MINOR ALTERATIONS DURING CONSTRUCTION IN THE INTEREST OF PRODUCT IMPROVEMENT.

| DATE               | STAGE            | DRN |
|--------------------|------------------|-----|
| XX/XX/XXXX         | XXXX             | X.X |
|                    |                  |     |
|                    |                  |     |
|                    |                  |     |
|                    |                  |     |
|                    |                  |     |
|                    |                  |     |
| SPECIFICATION: N/A | DAP: XXXXXX XXXX |     |

|           |                    |
|-----------|--------------------|
| CLIENT    | <b>PRELIMINARY</b> |
| ADDRESS   |                    |
| JOB NO.   |                    |
| SHEET NO. | 1 OF 1             |
| SCALE     | NOT TO SCALE       |